



DC
LANE

SELL • LET • MANAGE

Nelson Gardens, Plymouth, PL1 5RH

Auction Guide £160,000 Leasehold

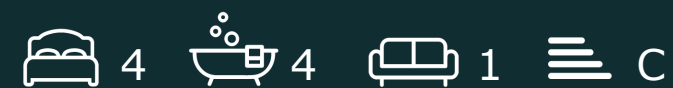



Nelson Gardens

Plymouth, PL1 5RH

- 1st Floor Apartment
- 3 Ensuites and One Family Bathroom
- Private Parking Area
- Balcony to Front
- Council Tax Band C
- 4 Spacious Bedrooms
- Close to Stoke Village
- Generous Accommodation
- Gas Central Heating
- EPC Grade C

GUIDE PRICE £150,000+ (plus fees). National Online Auction. Bidding Opens Monday 21th April 2025 at 13:00 and Closes 24hrs Later. A four bedroom four bathroom first floor apartment located in a Grade 2 listed building. Parking.

Description

GUIDE PRICE £150,000+ (plus fees). National Online Auction. Bidding Opens Monday 14th April 2025 at 13:00 and Closes 24hrs Later. A four bedroom four bathroom first floor apartment located in a Grade 2 listed building. Parking. Legal Pack via our website.

First Floor Apartment

A spacious and well presented four bedroom first floor apartment situated in a Grade 2 listed period building in Stoke, Plymouth. The property boasts three en-suite bathrooms, a balcony and private parking.

ACCOMMODATION Lounge 5.13m x 4.05m

Kitchen / Living Room 5.35m x 7.90m

Bedroom One 4.73m x 5.52m

En Suite One 2.53m x 1.53m

Bedroom Two 3.05m x 5.52m

En Suite Two 1.76m x 1.24m

Bedroom Three 2.53m x 5.43m

En Suite Three 1.59m x 1.22m

Bedroom Four 2.54m x 4.05m

Bathroom 1.99m x 1.65m

Utility Room 3.46m x 1.24m

FULL DETAILS Photographs, Dimensions, Floor Plans and Area Measurements (when available) are included within our full details online on our website. All published information is to aid identification of the property and is not necessarily to scale.

VIEWINGS Block viewing sessions will be held in the lead up to the auction. Please telephone Auction House South West on 03456 461361 to request a viewing.

NOTICE TO BIDDER Please be aware that if your Bid is successful on Auction day the exchange of contracts will happen immediately after the Auction.

EPC Rating: EPC Rating C76



Auction Guide £160,000



Kitchen/Living	17'6" x 25'11" (5.35 x 7.9)
Utility Room	11'4" x 4'0" (3.46 x 1.24)
Lounge	16'9" x 13'3" (5.13 x 4.05)
Bed 1	15'6" x 18'1" (4.73 x 5.52)
Bed 2	10'0" x 18'1" (3.05 x 5.52)
Bed 3	8'3" x 17'9" (2.53 x 5.43)
Bed 4	8'3" x 13'3" (2.54 x 4.05)
Bathroom	6'6" x 5'4" (1.99 x 1.65)
Ensuite 1	8'3" x 5'0" (2.53 x 1.53)
Ensuite 2	5'9" x 4'0" (1.76 x 1.24)
Ensuite 3	5'2" x 4'0" (1.59 x 1.22)



Directions

Head south on Mutley Plain/B3250 towards Belgrave Rd. Continue on Ford Park Rd. Take Central Park Ave, Stuart Rd, Wilton St and Valletort Rd to Nelson Gardens in Stoke

Scan for Material Information



Council Tax Band: C





Floor Plans

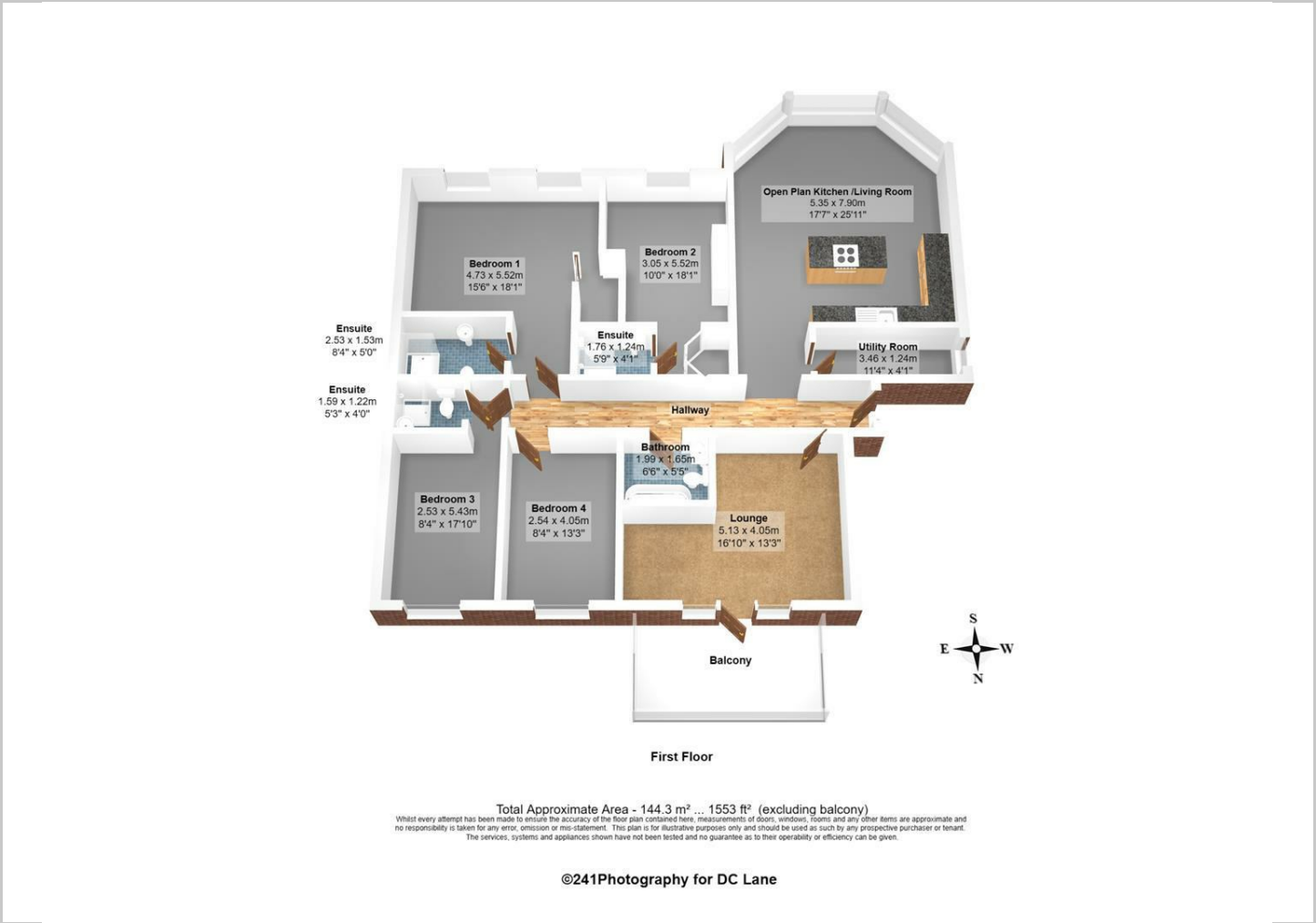

Viewing

Please contact our DC Lane, Plymouth Office on 01752 874242 if you wish to arrange a viewing appointment for this property or require further information.

The particulars are set out as a general outline only for the guidance of intended purchasers or lessees, and do not constitute, any part of a contract. Nothing in these particulars shall be deemed to be a statement that the property is in good structural condition or otherwise nor that any of the services, appliances, equipment or facilities are in good working order. Purchasers should satisfy themselves of this prior to purchasing.

Location Map

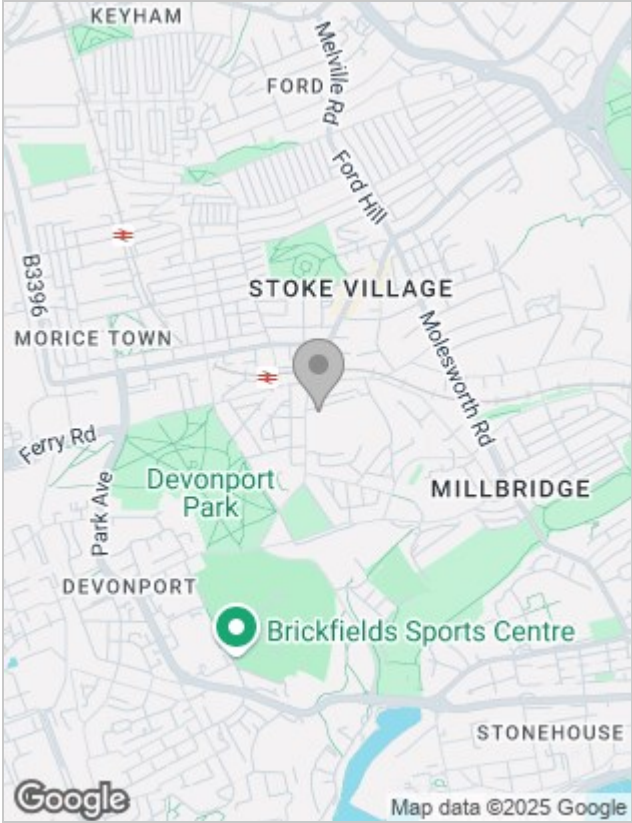

Energy Performance Graph

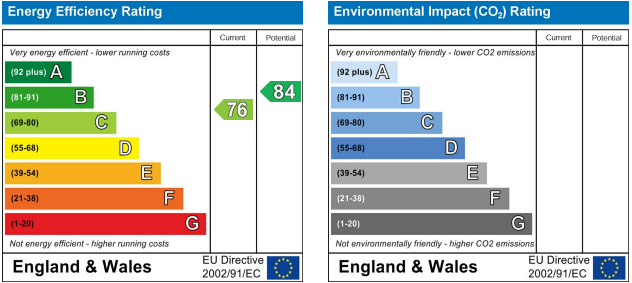

99 Mutley Plain, Mutley, Plymouth, Devon, PL4 6JJ
01752 874242 | hello@dclane.co.uk | www.dclane.co.uk