

DC
LANE

SELL • LET • MANAGE

Morley Court, Plymouth, PL1 1SL

Offers Over £105,000 Leasehold

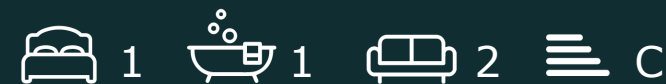



Morley Court

Plymouth, PL1 1SL

- Purpose Built Apartment
- City Centre Location
- Communal Launderette
- Cash Purchasers Only
- No Chain
- One Double Bedroom
- Two Lifts in Building
- Plymouth Roofscape Views
- Furniture Can Be Included
- Council Tax Band A

DC Lane are delighted to present this superb apartment located in the very heart of Plymouth's city centre offering easy access to all the amenities and attractions that Plymouth has to offer, whether you enjoy shopping, dining out, or exploring the city's cultural scene, everything is just a stone's throw away from your doorstep.

Previously a two bedroom apartment and easily reinstated, this lovely apartment is positioned on the seventh floor and benefits from two lifts and stairwell access. With security intercom system the accommodation comprises of sitting room, snug room, kitchen/breakfast room, double bedroom and well appointed shower room. Elevated uninterrupted views over the city roofscape towards Plymouth Sound and beyond to Cornwall can be enjoyed providing a picturesque backdrop to your daily life.

Further attributes include a communal launderette open 24/7, a communal garden for residents to enjoy, an external shed for the apartment and the potential to rent a garage from the local council.

Renovated 4 years ago with a new kitchen and bathroom, the gas central heating boiler installed 5 years ago has been serviced annually aswell as the property being rewired. and a fire sprinkler system.

With no onward chain we believe this delightful apartment would suit first time buyers for the enviable location experiencing city living at it's finest and a viewing is most definitely recommended.

Please note the furniture can be included in the sale.

This is available to cash purchasers only

Offers Over £105,000



Seventh Floor

Living Room 11'1" x 20'11" (3.40 x 6.40)

Snug 8'11" x 12'3" (2.74 x 3.75)

Kitchen/Breakfast Room 9'1" x 10'7" (2.78 x 3.24)

Bedroom 8'10" x 16'4" (2.71 x 5.00)

Shower Room 7'11" x 9'6" (2.43 x 2.90)





Directions

Head south on Mutley Plain/B3250 Turn right onto North Hill/B3250 Continue to follow B3250 0.5 mi Turn left onto Charles St/A374 0.2 mi At Charles Cross Roundabout, take the 4th exit onto Exeter St 0.2 mi At St Andrews Cross Roundabout, take the 3rd exit onto Royal Parade 0.3 mi At Derrys Cross Roundabout, take the 3rd exit onto Raleigh St 0.2 mi Raleigh St turns left and becomes New George St 217 ft New George St turns right and becomes Market Ave 381 ft Market Ave turns right and becomes Cornwall St 66 ft Turn left onto Market Way 95 ft Turn left onto Morley Ct 125 ft and the property

Council Tax Band: A

Scan for Material Information





Floor Plans

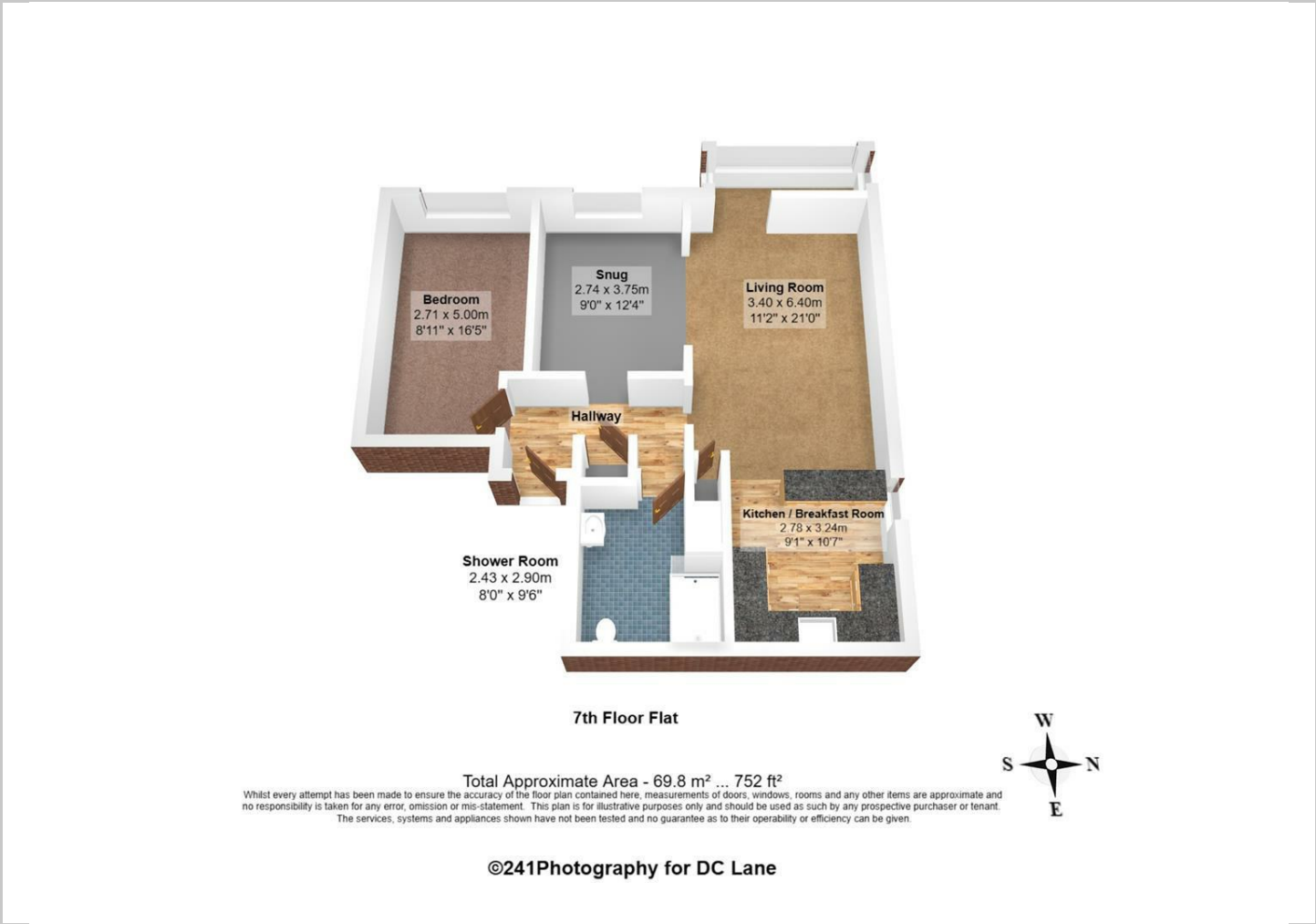

Viewing

Please contact our DC Lane, Plymouth Office on 01752 874242 if you wish to arrange a viewing appointment for this property or require further information.

The particulars are set out as a general outline only for the guidance of intended purchasers or lessees, and do not constitute, any part of a contract. Nothing in these particulars shall be deemed to be a statement that the property is in good structural condition or otherwise nor that any of the services, appliances, equipment or facilities are in good working order. Purchasers should satisfy themselves of this prior to purchasing.

Location Map

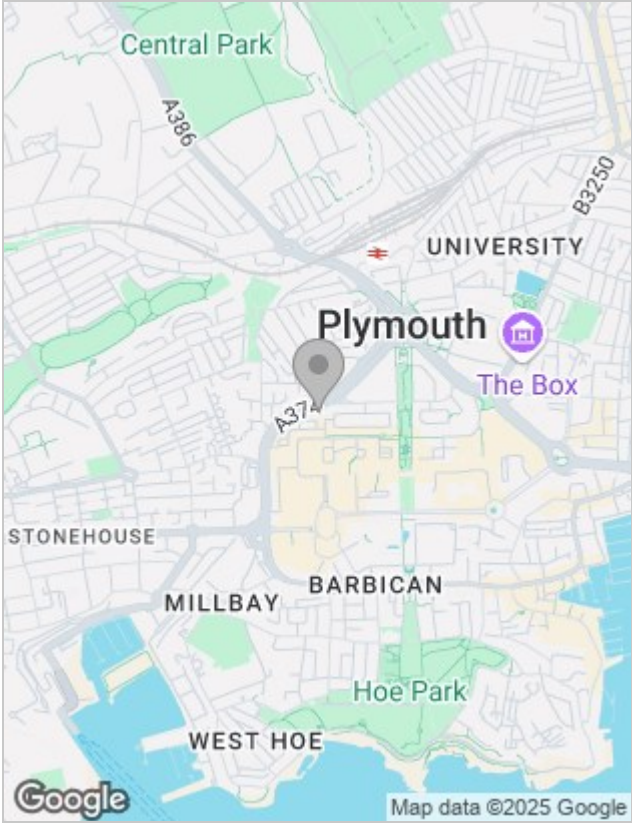

Energy Performance Graph

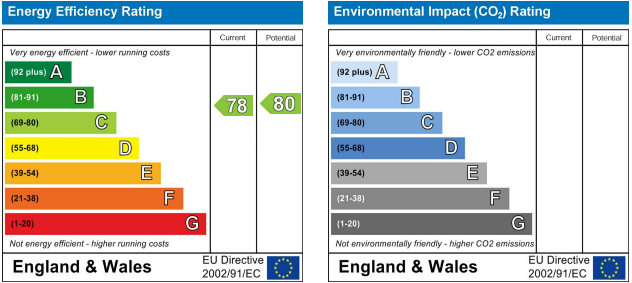

99 Mutley Plain, Mutley, Plymouth, Devon, PL4 6JJ
01752 874242 | hello@dclane.co.uk | www.dclane.co.uk