



DC
LANE

SELL • LET • MANAGE

Morley Court
PL1 1SH

Morley Court
PL1 1SH

Morley Court, Plymouth, PL1 1SH
£105,000 Leasehold

2 1 1 D



£105,000

Morley Court

Plymouth, PL1 1SH

- Purpose Built Apartment
- Central Location
- Well Presented
- Ideal FTB/Buy To Let
- No Onward Chain
- Two Double Bedrooms
- Positioned on Third Floor
- Spacious Accommodation
- Elevated City Views
- Council Tax Band A

Welcome to Morley Court, a third floor apartment located in the heart of Plymouth's city centre. This purpose-built apartment offers a tastefully presented living space with spacious accommodation, perfect for those looking for a comfortable and convenient lifestyle.

With one reception room, two double bedrooms, generous kitchen/diner and a well-appointed bathroom, this apartment is ideal for individuals or small families seeking a modern urban dwelling. The property boasts south facing elevated views towards Mount Edgcumbe and Cornwall aswell as glimpses of iconic Plymouth landmarks, providing a picturesque backdrop to your daily life.

Situated in a prime location, Morley Court offers easy access to all the amenities and attractions that Plymouth has to offer. Whether you enjoy shopping, dining out, or exploring the city's cultural scene, everything is just a stone's throw away from your doorstep.

With no onward chain don't miss the opportunity to make this delightful apartment your new home. Experience city living at its finest at Morley Court.



Third Floor

Lounge	16'6" x 11'0" (5.03 x 3.37)
Kitchen/Diner	12'11" x 11'0" (3.95 x 3.37)
Bedroom One	8'11" x 14'6" (2.74 x 4.43)
Bedroom Two	9'4" x 11'3" (2.86 x 3.44)
Bathroom	5'6" x 7'8" (1.70 x 2.36)





Directions

Head south on Mutley Plain/B3250 Turn right onto North Hill/B3250 Continue to follow B3250 0.5 mi Turn left onto Charles St/A374 0.2 mi At Charles Cross Roundabout, take the 4th exit onto Exeter St 0.2 mi At St Andrews Cross Roundabout, take the 3rd exit onto Royal Parade 0.3 mi At Derrys Cross Roundabout, take the 3rd exit onto Raleigh St 0.2 mi Raleigh St turns left and becomes New George St 217 ft New George St turns right and becomes Market Ave 381 ft Market Ave turns right and becomes Cornwall St 66 ft Turn left onto Market Way 95 ft Turn left onto Morley Ct 125 ft and the property

Council Tax Band: A

Scan for Material Information





Floor Plans

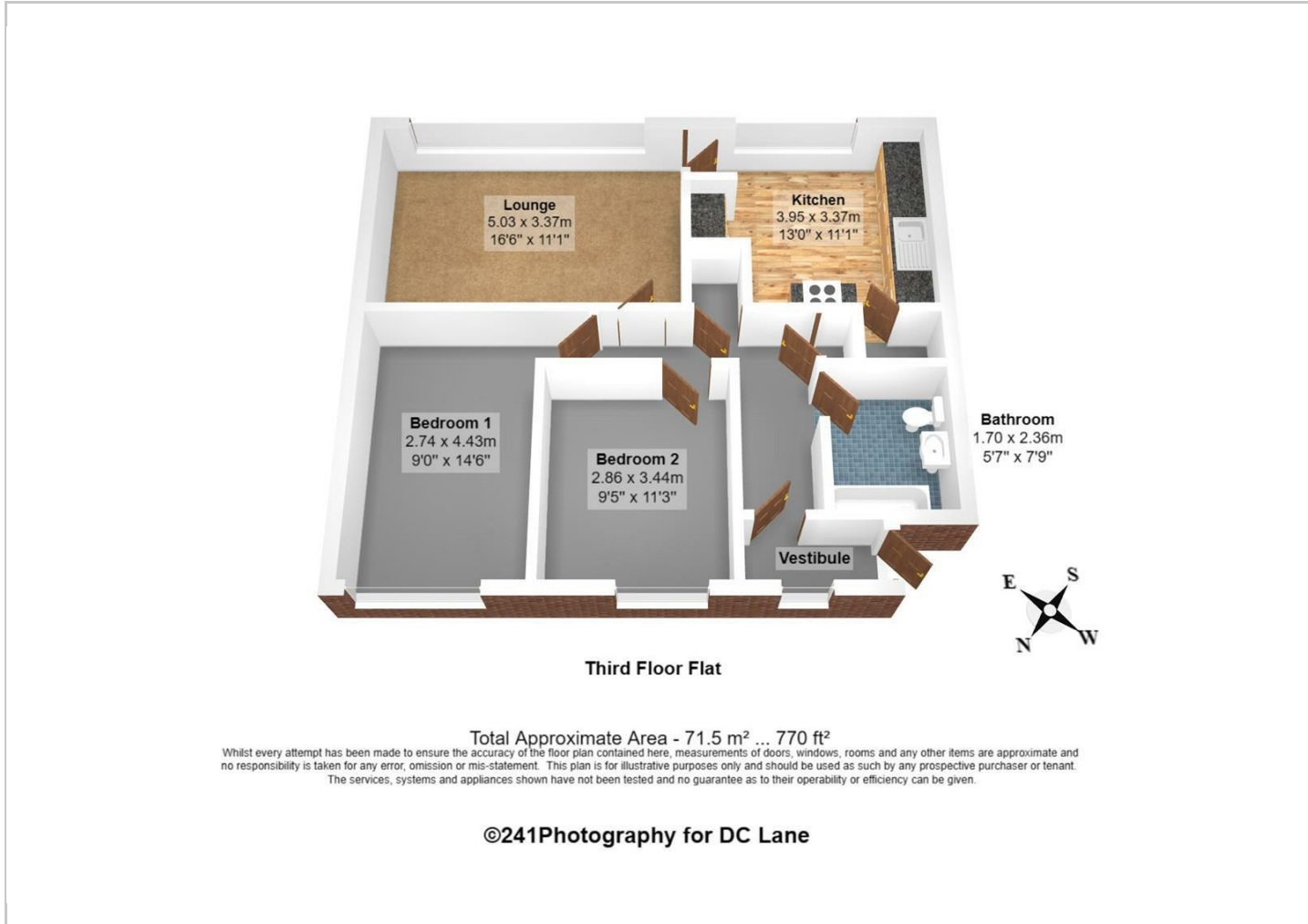

Viewing

Please contact our DC Lane, Plymouth Office on 01752 874242 if you wish to arrange a viewing appointment for this property or require further information.

The particulars are set out as a general outline only for the guidance of intended purchasers or lessees, and do not constitute, any part of a contract. Nothing in these particulars shall be deemed to be a statement that the property is in good structural condition or otherwise nor that any of the services, appliances, equipment or facilities are in good working order. Purchasers should satisfy themselves of this prior to purchasing.

Location Map

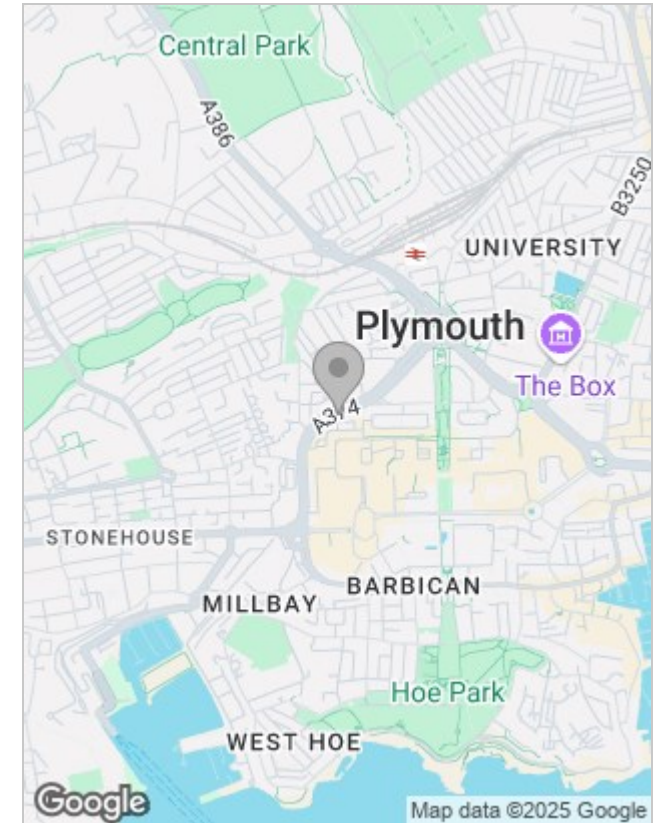

Energy Performance Graph

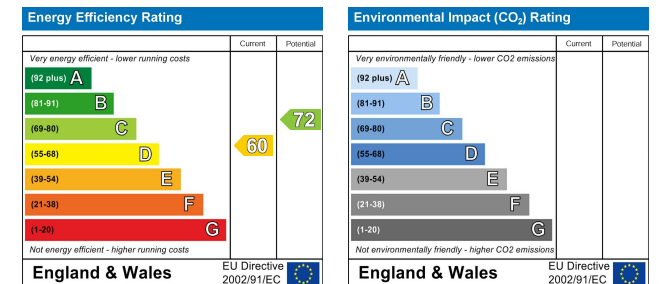

99 Mutley Plain, Mutley, Plymouth, Devon, PL4 6JJ
01752 874242 | hello@dclane.co.uk | www.dclane.co.uk